

## Gas Pasta Cooker

The pasta cookers are among the industry's most reliable and trusted equipment with highly efficient burners and a variety of basket configurations. They can be used to cook fresh or dry pasta.

### PRODUCT SPECIFICATIONS --

- Open pot structure, transfers heat to plates located strategically outside of the frypot
- Intense heat rapidly heats the stainless steel sides and the water inside of the frypot
- Behind the door snap action millivolt control, Doesn't require electric connection
- The temperature control range 200°F-400°F (93°C-205°C)
- Over temperature protection on 450°F (232°C), more than it, cut off gas
- Four stainless steel adjustable legs
- Large cold zone. captures and holds particles out of the heating zone, reduces taste transfer

CP-VPC50



### PLAN VIEWS --

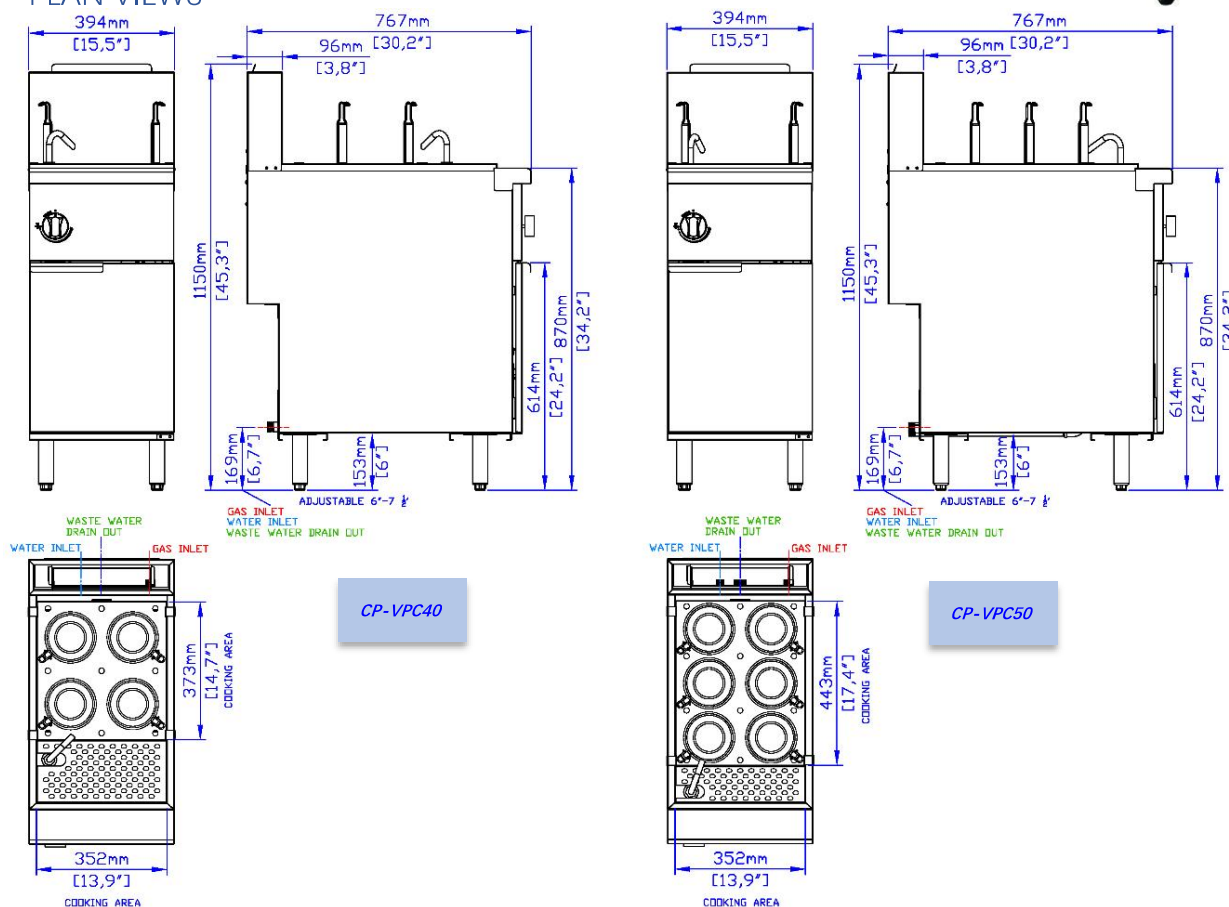

### MODEL LIST --

Model	Gas Type	Gas Pressure	Total BTU	Water Capacity	Overall Dimensions	Net Weight	Package Size	Shipping Weight
CP-VPC40	Natural Gas	4" W.C.	100,000	40-46 lbs 4.7-5.5 gal	15 5"x 30.2"x 45.3" 39.4 x 76.7 x 115 cm	139 lbs 63 kg	16.6"x 32.3"x 33.5" 42 x 82 x 85 cm	158 lbs 72 kg
CP-VPC40	Liquid Propane	10" W.C.	100,000	40-46 lbs 4.7-5.5 gal	15 5"x 30.2"x 45.3" 39.4 x 76.7 x 115cm	139 lbs 63 kg	16.6"x 32.3"x 33.5" 42 x 82 x 85 cm	158 lbs 72 kg
CP-VPC50	Natural Gas	4" W.C.	122,000	47-55 lbs 5.7-6.63 gal	15 5"x 30.2"x 45.3" 39.4 x 76.7 x 115 cm	149 lbs 67.5 kg	16.6"x 32.3"x 33.5" 42 x 82 x 85 cm	167 lbs 76 kg
CP-VPC50	Liquid Propane	10" W.C.	122,000	47-55 lbs 5.7-6.63 gal	15 5"x 30.2"x 45.3" 39.4 x 76.7 x 115 cm	149 lbs 67.5 kg	16.6"x 32.3"x 33.5" 42 x 82 x 85 cm	167 lbs 76 kg

- This appliance is manufactured for commercial installation only, not intended for home use.
- Gas connections 3/4" Male NPT. Supply gas pressure not to exceed 14" W.C.(1/2 PSI)
- An adequate ventilation system is required for Commercial Cooking Equipment.
- Water connection 1/2"Male NPT
- Waste water drain connection 1"Male NPT
- Require a 6" clearance at both side and rear adjacent to combustible construction.
- ETL design certified NSF listed
- Unit are not supplied with conversion kits, Gas type must select before ordering.

#### Options & Accessories

- Caster set (2 locking, 2 non-locking)



Intertek

Intertek