

焼き鳥店導入例

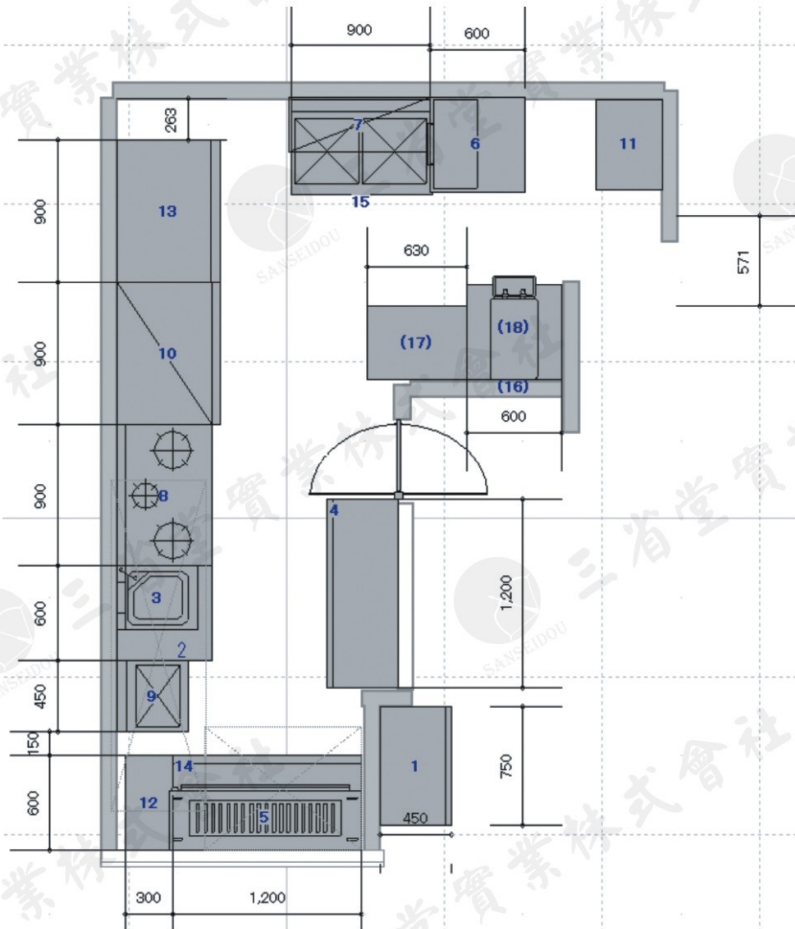
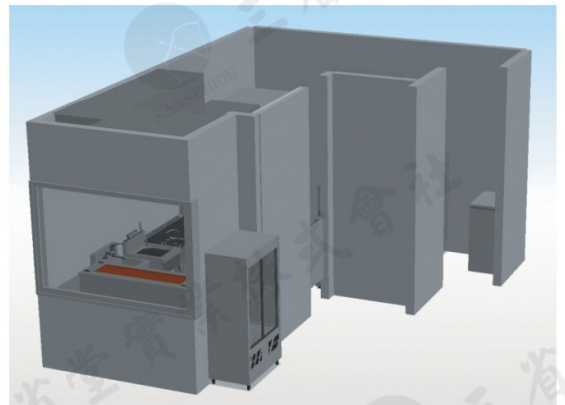
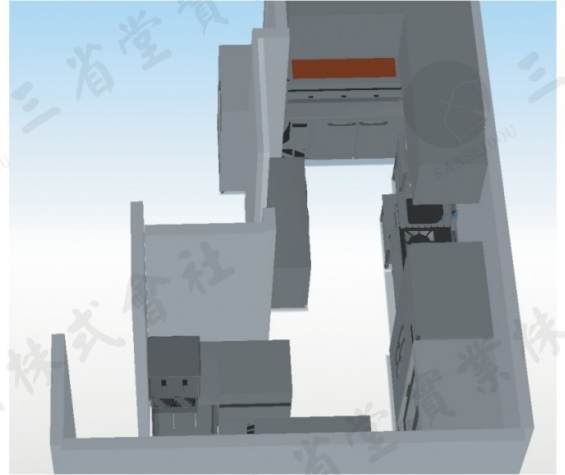
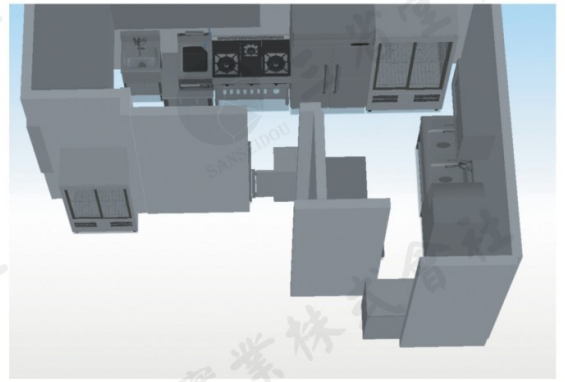

| 番号 (NO.) | 品名(NAME) | 品番(CODE) | 寸法(SIZE) | | | 数量 (QUANTITY) |
|-------------|--|-------------|----------|-----|------|------------------|
| | | | W | D | H | |
| 1 | 冷蔵ショーケース/Refrigerated showcase/立式冷蔵展示櫃 | SMB-H129NB | 750 | 450 | 1395 | 1 |
| 2 | 作業台/Work table/工作台 | BW-066 | 600 | 600 | 800 | 1 |
| 3 | 卓上ガスフライヤー/Tabletop gas fryer/台式燃氣油炸爐 | MGF-C 12TJ | 400 | 510 | 600 | 1 |
| 4 | 横型冷蔵庫/Undercounter Refrigerator with 2 doors/横型冷蔵庫 | SUC-N1241J | 1200 | 450 | 800 | 1 |
| 5 | ガス式焼物器/Gas griller/燃氣燒烤爐 | SC1 | 1220 | 416 | 266 | 1 |
| 6 | 食器洗浄機/Dish washer/洗碗機 | DJWE-450V | 600 | 615 | 1300 | 1 |
| 7 | 吊戸棚/Hanging cupboard/吊櫃 | BCS6-0935 | 900 | 350 | 600 | 1 |
| 8 | ガステーブル/Table style gas range/落地式平頭爐 | RGT-0963C | 900 | 600 | 800 | 1 |
| 9 | 1槽流し台/1 tank type sink/1槽水槽 | BS1-044 | 450 | 450 | 800 | 1 |
| 10 | 縦型冷凍冷蔵庫/refrigerator-freezer/立式冷凍冷蔵庫 | SRR-K961C2 | 900 | 650 | 1950 | 1 |
| 11 | 冷凍ストッカー/Freezer with upward opening door/上開式冷凍冰櫃 | 60-OR | 415 | 571 | 848 | 1 |
| 12 | 作業台/Work table/工作台 | BW-036 | 300 | 600 | 800 | 1 |
| 13 | 冷蔵ショーケース/Refrigerated showcase/立式冷蔵展示櫃 | SRM-RV319B | 900 | 650 | 1900 | 1 |
| 14 | 横型冷蔵庫/Undercounter Refrigerator with/横型冷蔵庫 | SUR-K1261SA | 1200 | 600 | 800 | 1 |
| 15 | 2槽ソイルドシンク/2 tanks type sink for soiled tableware/2槽清洗前餐具水槽 | 特注 | 900 | 600 | 1100 | 1 |
| 16 | ビールサーバー台/Beer server table/生啤酒機放置台 | BW-066 | 600 | 600 | 800 | 1 |
| 17 | 製氷機/Ice Maker/製氷機 | DRI-45LME | 630 | 450 | 800 | 1 |
| 18 | ビールサーバー/Beer server/生啤機 | 既存品 | 300 | 650 | 470 | 1 |
| 合計 | | | | | | 18 |